

DISTANCE REMAINING (SIZE 4) LED LIGHTING SYSTEM

Sign Drawing

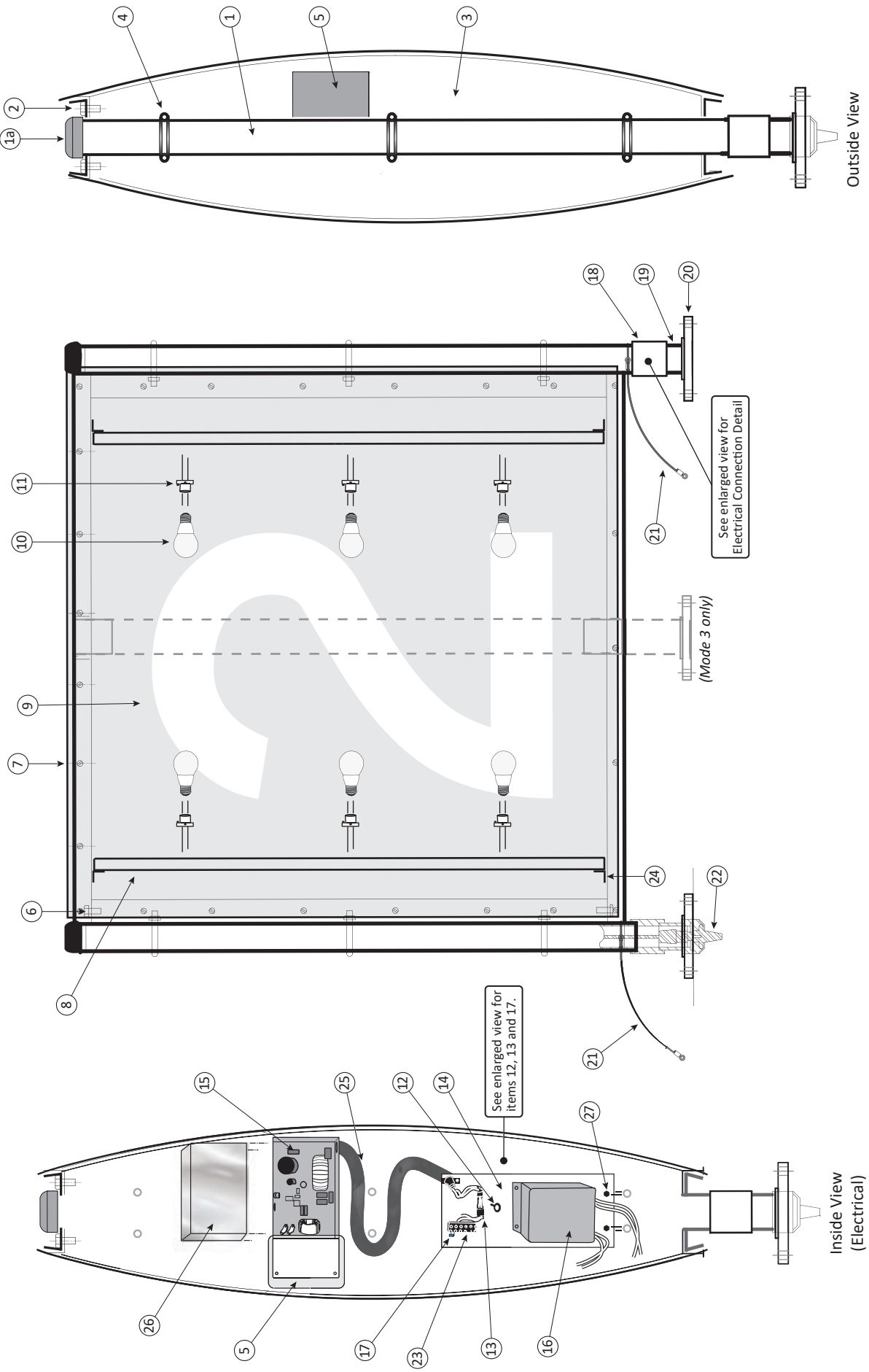

To order parts, or have questions, call **800-258-1997**.

View reference documents, visit www.lumacurve.com/documents

	ITEM	DESCRIPTION
1a.	DCLT-1A	Leg Cap
*1.	D-1	Leg
2.	D-2XHD	Top/Bottom Channel
3.	DTG-2	End Panel
*4.	D-4/D-4AA/370/360	U-bolts w/ nuts & washers
5.	D-3/D-3B	Access Door
6.	215/220/230/232	1/4" Hardware
7.	394 Face Hardware	1/4" x 3/4" Hex Head
8.	D-8P	Light Bar
9.	D-15	48" x 48" Legend Panel
10.	LED Lamp	4W LED Lamp
11.	500	Lamp holder
12.	G Ferrite A	Ferrite Core Split
13.	G Ferrite B	Ferrite Core Not Split
14.	480	Cable Clamp
15.	L610	LED PCB Controller, DC (1-12 lamps)

	ITEM	DESCRIPTION
16.	G Low Pass Filter	ALD Low Pass Filter
17.	E416	Surge Protector
*18.	2" AL Coupling	2" Pipe Coupling
*19.	140A	Frangible Coupling - 2600 ft/lbs
20.	15-XHDT	5" x 8" Aluminum Floor Flange
21.	190 - 3/16"	Tether
22.	430	Cord & Plug
23.	420	Terminal Strip (6 block)
24.	PS Bracket	Angle Brackets
25.	3/8" Conduit	Flexible Conduit
26.	G EMI Shield Screen	Controller Screen
27.	360	3/8" Hardware

* Mode 3 parts may be different or not listed here
Please see the DM MODE 3 parts list

