

To order parts, or have questions, call 800-258-1997.

View reference documents, visit www.lumacurve.com/documents

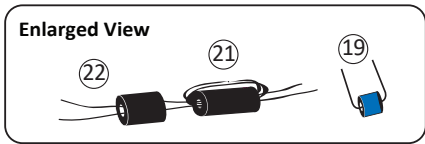
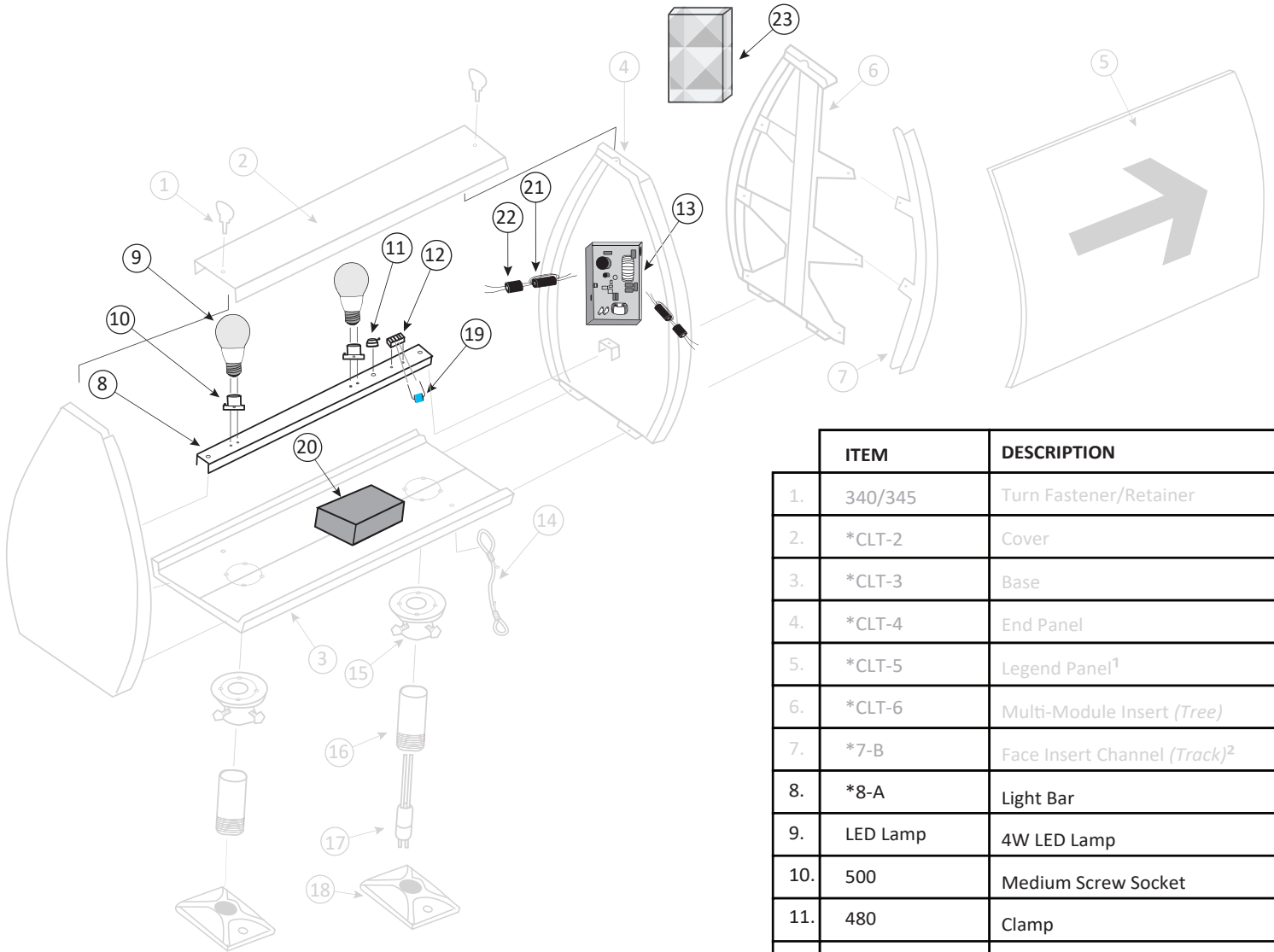

	ITEM	DESCRIPTION
1.	340/345	Turn Fastener/Retainer
2.	*CLT-2	Cover
3.	*CLT-3	Base
4.	*CLT-4	End Panel
5.	*CLT-5	Legend Panel ¹
6.	*CLT-6	Multi-Module Insert (Tree)
7.	*7-B	Face Insert Channel (Track) ²
8.	*8-A	Light Bar
9.	LED Lamp	4W LED Lamp
10.	500	Medium Screw Socket
11.	480	Clamp
12.	420	Terminal Strip
13.	L610	LED PCB Controller
14.	190 - 3/16"	Tether
15.	130 PH	Slipfitter
16.	140-S3M2	6" Frangible Coupling
17.	430	Cord & Plug
18.	15	Floor Flange
19.	E416	Surge Protector
20.	G Filter	ALD Low Pass Filter
21.	G Ferrite A	Ferrite Core Split
22.	G Ferrite B	Ferrite Core Not Split
23.	G EMI Shield	Controller Screen

To help in placing your order:

- * Prefix part number with one of the following sign sizes:
 "S" (Small/Size 1), "M" (Medium/Size 2), "L" (Large/Size 3)
- 1 Specify one of the following sign types:
 L-858Y ("Y"ellow), L-858R ("R"ed), L-858L ("L"ocation), or Blank/ Black
- 2 Specify one of the following track colors:
 (B) Black, (Y) Yellow or (R) Red